

Replacement Parts for Glass Filler & Sink

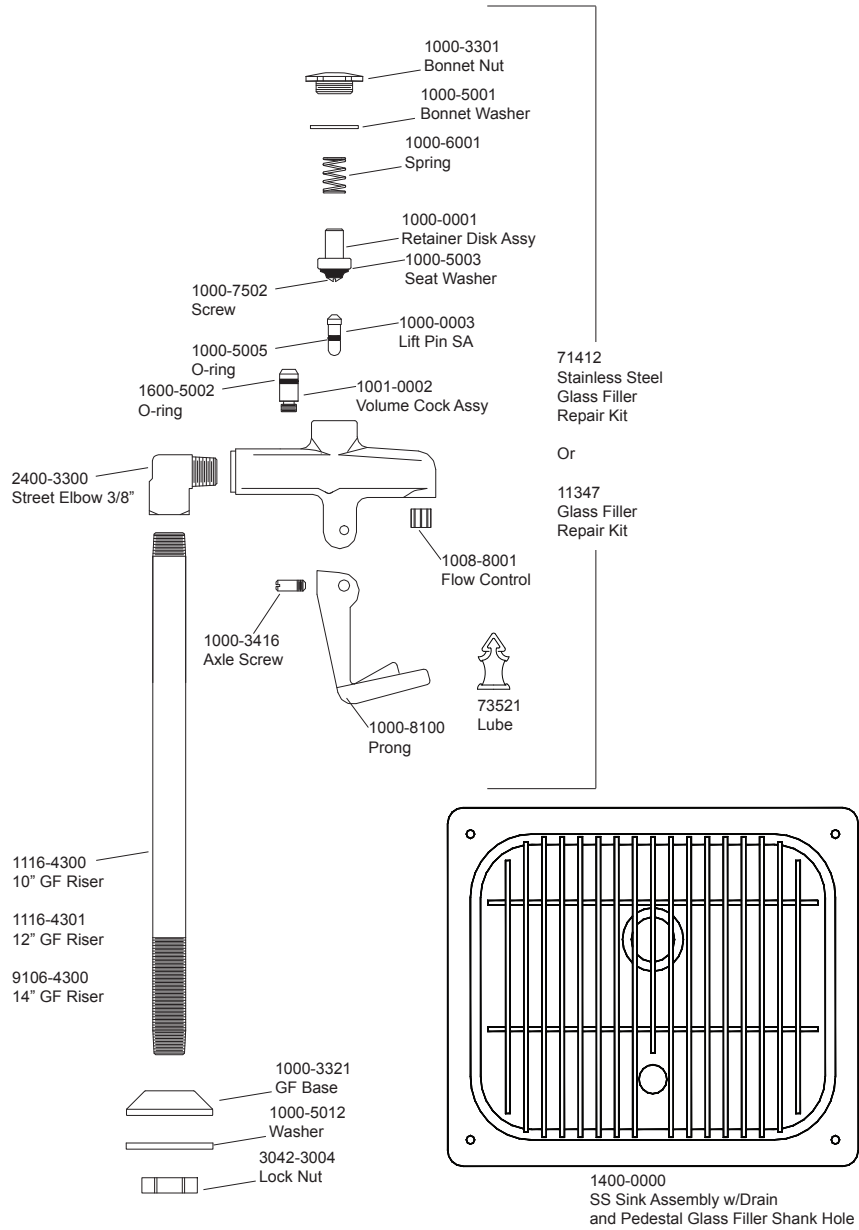

FISHER
 MANUFACTURING COMPANY
 PO BOX 60, TULARE, CA 93275
 (800)421-6162, FAX: (800)832-8238
 www.fisher-mfg.com



GFHB-WSP2-XX Product Installation Guide

Since 1936, Fisher Manufacturing Company has manufactured heavy-duty, high quality plumbing products and hardware specialties for the food service industry. For three generations, the Fisher family has adhered to a strict dedication of and overall value. When you install Fisher products... you install the best. Our hardware is manufactured with the standardization of internal mechanisms. All chrome plating is triple plated copper, nickel and chrome for durability. Every piece of equipment we make is rigorously tested in both our modern in-house testing center and in actual field situations under extreme conditions. Every detail is thoroughly checked. Before we make our products available to you, they pass each and every test. You get proven performance. Guaranteed.



Limited One Year Warranty

Fisher Manufacturing Company warrants its products and parts thereof (except as noted below) against defects in materials or workmanship for a period of one year after the date of original purchase. During this period Fisher Manufacturing Company will replace a defective product or part without charge to you, provided that the entire product is delivered to Fisher Manufacturing Company. All transportation and insurance charges for shipping the product to and from Fisher Manufacturing Company must be borne by you. Charges for transportation and insurance may, at the option of Fisher Manufacturing Company, be refunded depending upon our investigation of the warranty claim. This warranty does not cover external finish (except at date of original purchase) or labor costs not specifically authorized by Fisher Manufacturing Company.

A full and complete copy of our One Year limited warranty is available upon request.

- #1400 10" Pedestal Glass Station
- #89494 12" Pedestal Glass Station
- #83895 14" Pedestal Glass Station

KEEP THIS MANUAL FOR FUTURE REFERENCE



ANSI/A112.18.1M, ANSI/NSF 61.9

FISHER MANUFACTURING COMPANY • TOLL FREE: 800-421-6162 FAX: 800-832-8238

Installation Instructions for Glass Filler w/ Sink Assembly

BE SURE TO CHECK WITH YOUR LOCAL DEPARTMENT HAVING JURISDICTION REGARDING BACKFLOW PREVENTION

Installation Notes:

- Be sure to shut off water supply before beginning.
- Use pipe thread sealant such as PST on all threaded joints.
- Check the packaging for missing items BEFORE beginning installation. If items are missing, contact your supplier.

Package Contents

The box should contain the following:



SS Sink Assembly
Qty: 1



Glass Filler Assembly
Qty: 1

Installation Instructions

Step 1.

After unpacking items and checking for missing components, Cut out rough in hole to the following dimensions below. Place the sink in the rough in hole with the 3/4" hole facing the back of the rough in. Mount down with the four screws.

Step 2.

Place the glass filler gasket on the glass filler shank, up against glass filler base, mount the glass filler shank through 3/4" hole. Place the waste socket gasket on the waste socket and mount through the 1-5/16". Underneath the sink place the pan stiffener through the glass filler shank and waste socket, place washers on the shank and tighten locking nuts.

Step 3.

Connect water supply line to the glass filler and plumb the waste socket. Turn on water supply and check for leaks.

Step 1 ROUGH-IN:

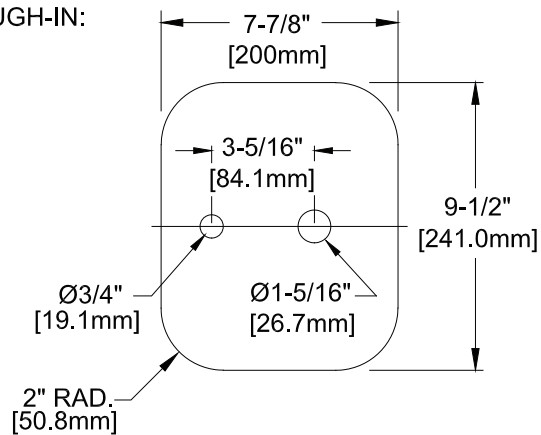

Installation Instructions Continued

Step 2

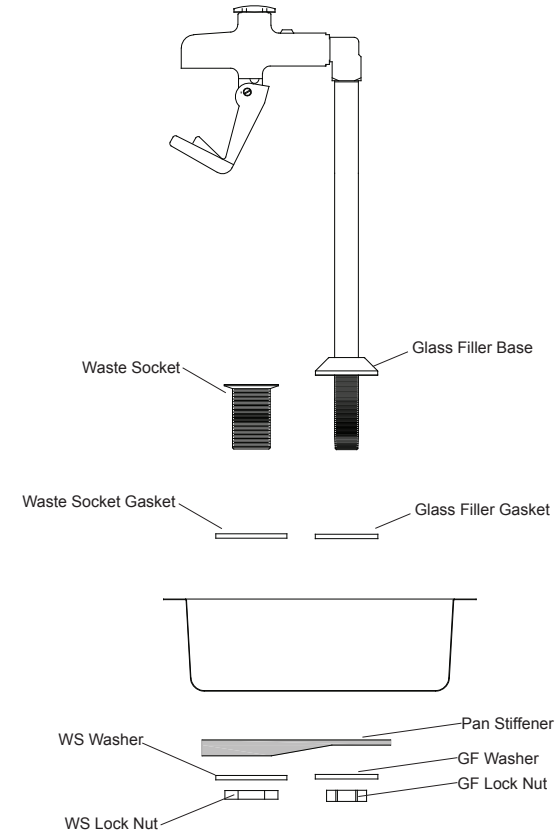

Step 3

