

# FISHER<sup>®</sup>

FISHER MANUFACTURING COMPANY TOLL FREE: 800-421-6162 - FAX: 800-832-8238  
customer@fisherfaucets.com - www.fisherfaucets.com

PRODUCT NAME:

CONTROL VALVE 8BSZLH R/S CD

SPEC. CV/CB-SO-8BSZLL

Customer/Wholesaler:	Date:	Job Name:	Model Specified: 63810	Quantity:
Contracter:	Architect/Engineer:			

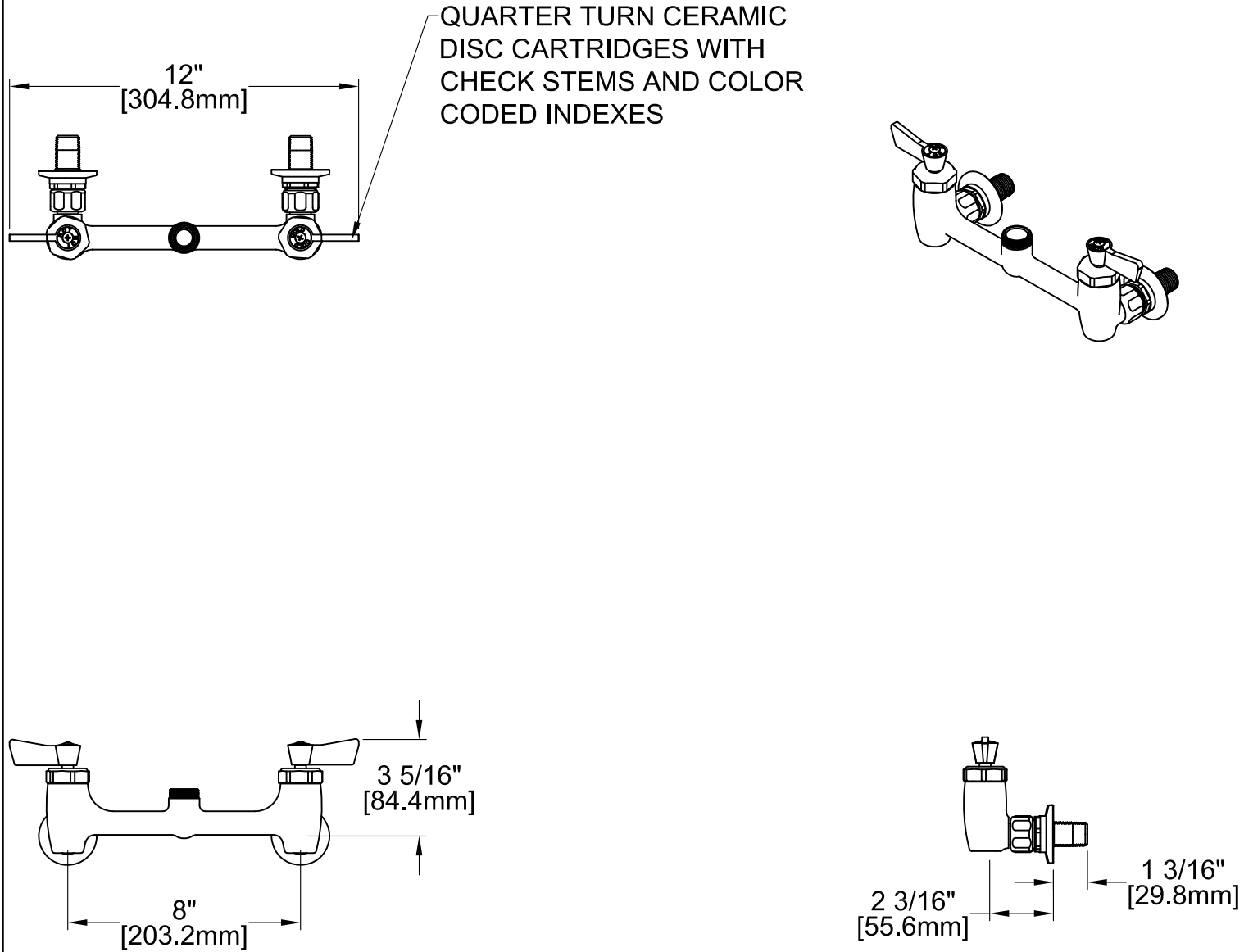

PRODUCT SPECIFICATIONS:  
8" BACKSPASH MOUNT MIXING FAUCET, QUARTER TURN CERAMIC DISC CARTRIDGES WITH LEVER HANDLES, 1/2" NPT CONCENTRICS INLET, EZ INSTALL KIT

PRODUCT COMPLIANCE:  
ASME A112.18.1 / CSA B125.1  
NSF 61 - Section 9  
NSF 372 (Low Lead Content)



FISHER MANUFACTURING COMPANY TOLL FREE: 800-421-6162 - FAX: 800-832-8238  
customer@fisherfaucets.com - www.fisherfaucets.com

PRODUCT NAME:

CONTROL VALVE 8BSZLH R/S CD

SPEC. CVCB-SO-8BSZLL

Customer/Wholesaler:	Date:	Job Name:	Model Specified: 63810	Quantity:
Contractor:		Architect/Engineer:		

NO.	QTY.	ITEM	NAME
1	2	2000-0002	HANDLE KIT LEVER
2	2	75957	BIBB CAP FAUCET CD NL BRS CR
3	1	75958	STEM 1/2 CERAMIC DISK LH
4	1	75959	STEM 1/2 CERAMIC DISK RH
5	2	22594	CONCENTRIC KIT BRS 1/2M
6	2	75557	EZ INSTALL KIT BRS T&S CHI KRN

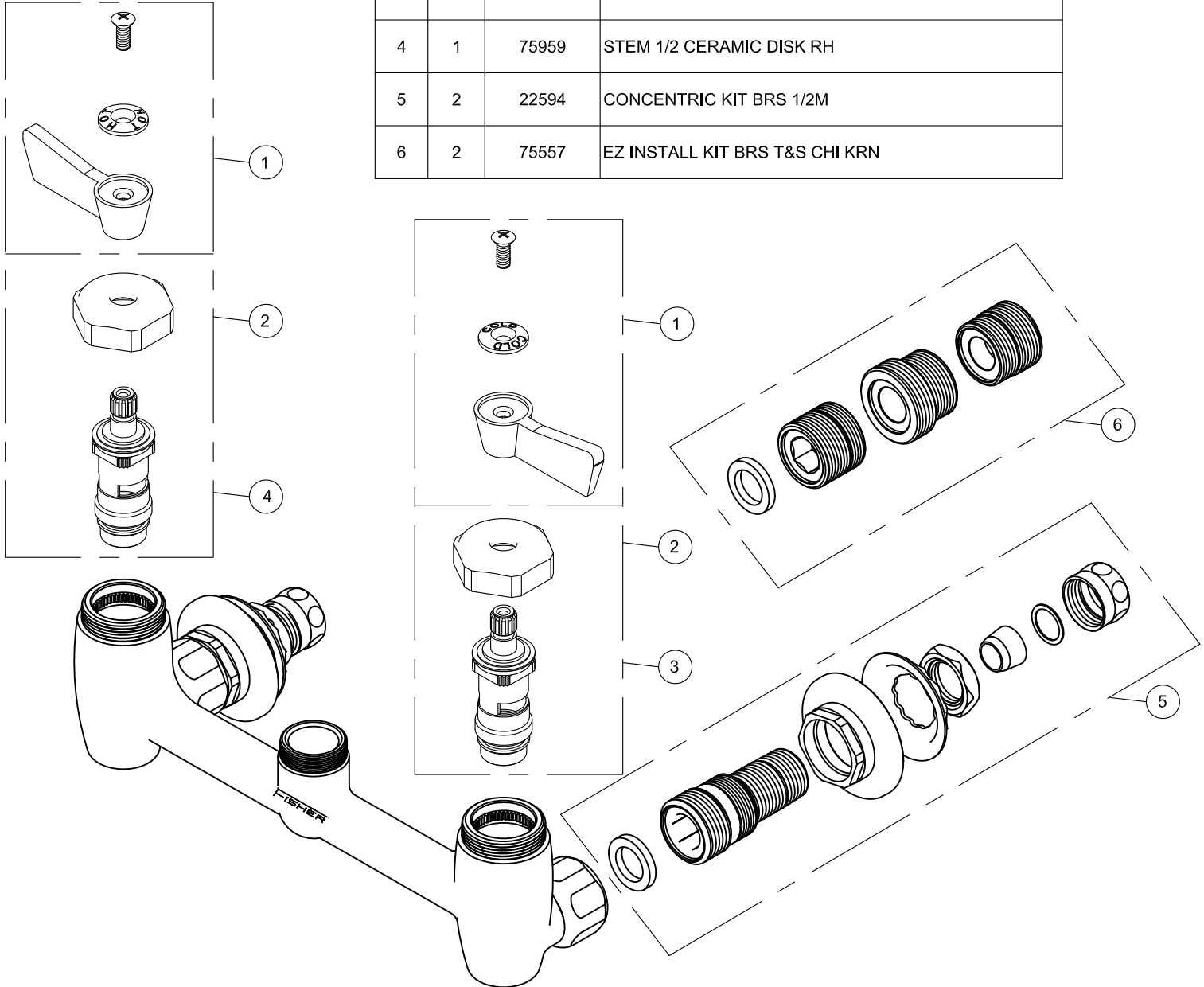

**PRODUCT SPECIFICATIONS:**  
8" BACKSPASH MOUNT MIXING FAUCET, QUARTER TURN CERAMIC DISK CARTRIDGES WITH LEVER HANDLES, 1/2" NPT CONCENTRICS INLET, EZ INSTALL KIT

**PRODUCT COMPLIANCE:**  
ASME A112.18.1 / CSA B125.1  
NSF 61 - Section 9  
NSF 372 (Low Lead Content)