

Customer/Wholesaler:	Date:	Job Name:	Model Specified:	Quantity:
Contractor:	Architect/Engineer:			

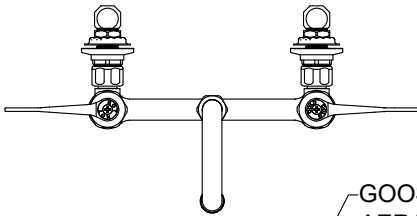

GOOSENECK SPOUT W/ 2.2 GPM
AERATOR 55/64-27F, CONVERTS
TO RIGID W/ SERRATED LOCK
WASHER, INCLUDED

QUARTER TURN
CERAMIC DISK CARTRIDGES
W/ CHECK STEMS
& COLOR CODED INDEXES

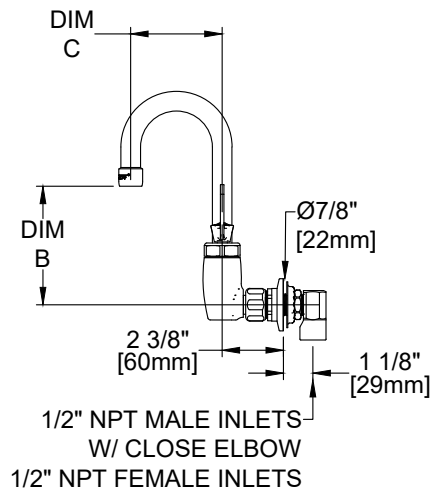
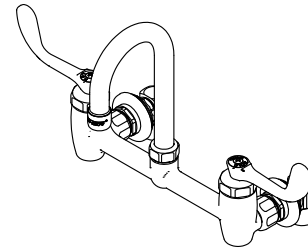
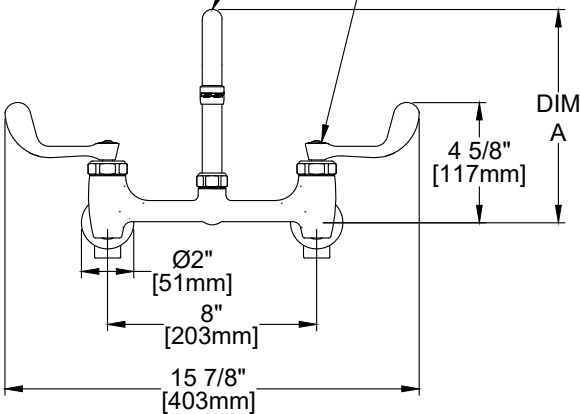

MODEL	DESCRIPTION	DIM A	DIM B	DIM C
55660	FAUCET 8BSCDWH 06SGN 2.20 GPM EL	8 3/16" [207mm]	4 9/16" [115mm]	3 1/2" [89mm]
55670	FAUCET 8BSCDWH 12SGN 2.20 GPM EL	12 15/16" [328mm]	8 9/16" [217mm]	5" [127mm]

PRODUCT SPECIFICATIONS: 8" BACKSPLASH FAUCET, QUARTER TURN CERAMIC DISK CARTRIDGES W/ CHECK STEMS, WRIST HANDLES, 6" OR 12" SWIVEL OR RIGID GOOSENECK SPOUT W/ 2.2 GPM @ 60 PSI AERATOR, 1/2" NPT MALE INLETS W/ CLOSE ELBOW 1/2" NPT FEMALE INLETS

PRODUCT COMPLIANCE:
ASME A112.18.1 / CSA B125.1
NSF 61 - Section 9
NSF 372 (Low Lead Content)

FISHER[®]

FISHER MANUFACTURING COMPANY TOLL FREE: 800-421-6162 - FAX: 800-832-8238
customer@fisherfaucets.com - www.fisherfaucets.com

PRODUCT NAME:

FAUCET 8BSCDWH SGN 2.20 GPM EL

Customer/Wholesaler:

Date:

Job Name:

Model Specified:

Quantity:

Contractor:

Architect/Engineer:

SPEC. FACB-BR-8BSEEWW

REPLACEMENT PARTS

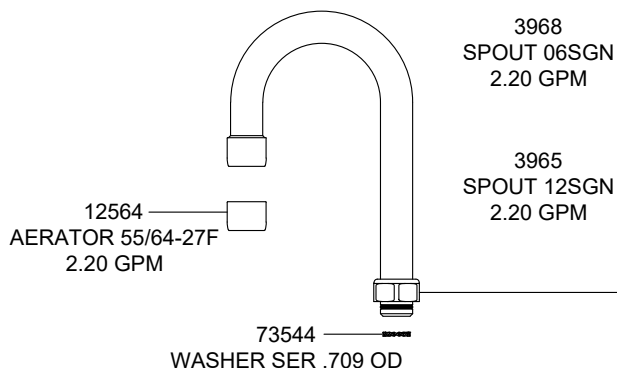

75964
PRERINSE CD
KIT

20020
SNAP RING

1600-5000
SPOUT O-RING
(2 REQD)

73521
O-RING LUBE



19119
O-RING
SPOUT
KIT

75964
PRERINSE CD
KIT

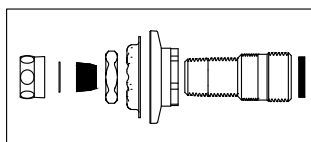

22594
CONCENTRIC KIT BRS 1/2M



2400-2103
CLOSE ELBOW
1/2F BRS

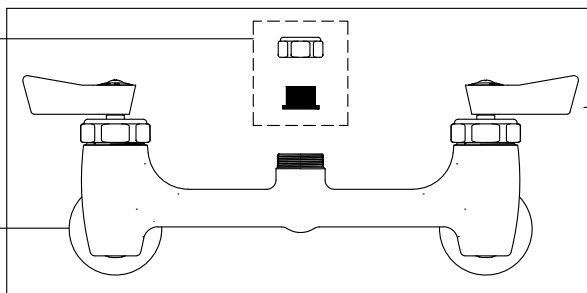

13150
CONTROL VALVE
8BSCDLH SVL/RIG

2000-7500
SCREW

2000-8000
RED BUTTON
2000-8001
BLUE BUTTON



WRIST
HANDLE



75957
BIBB CAP CD



75958
STEM 1/2 CERAMIC
DISK LH



75959
STEM 1/2 CERAMIC
DISK RH



73521
O-RING LUBE

3984
WRIST HANDLE KIT
INCLUDES:
SCREW
RED BUTTON
BLUE BUTTON
WRIST HANDLE

PRODUCT SPECIFICATIONS: 8" BACKSPASH FAUCET, QUARTER TURN CERAMIC DISK CARTRIDGES W/ CHECK STEMS, WRIST HANDLES, 6" OR 12" SWIVEL OR RIGID GOOSENECK SPOUT W/ 2.2 GPM @ 60 PSI AERATOR, 1/2" NPT MALE INLETS W/ CLOSE ELBOW 1/2" NPT FEMALE INLETS

PRODUCT COMPLIANCE:
ASME A112.18.1 / CSA B125.1
NSF 61 - Section 9
NSF 372 (Low Lead Content)

Drawn: LC

Checked: EM

Approved: LC

Date: 08/01/25

Sheet: 2 of 2