

Customer/Wholesaler:	Date:	Job Name:	Model Specified:	Quantity:
Contractor:		Architect/Engineer:		

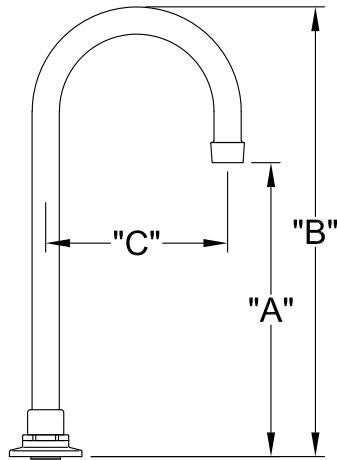

1/2" SLIP JOINT

MODEL:

- 3816 FAUCET BD 12RGN PER 2.20 GPM
- 73380 FAUCET BD 12RGN PCA SPRAY 0.35 GPM
- 1937 FAUCET BD 06RGN PER 2.20 GPM
- 73381 FAUCET BD 06RGN PCA SPRAY 0.35 GPM

OPTIONS OR MODIFICATIONS:

- OTHER _____

FEATURES:

- * SINGLE BASE DECK
- * RIGID GOOSENECK SPOUT
- * 1/2" SLIP JOINT

SYSTEM LIMITS

- * TEMP: 40°F MIN. TO 160°F MAX.
- * PRESSURE 200 PSI MAX. STATIC
- * 2.20 GPM AT 60 PSI (8.3L/min @ 410 kPa)
- * 0.35 GPM AT 60 PSI (1.3 L/min @410 KPa)

SHIPPING WEIGHT

- * 2.0 LBS

PRODUCT COMPLIANCE:

- * ASME A112.18.1 / CSA B125.1
- * NSF 61 - Section 9
- * NSF 372 (Low Lead Content)

MODEL	DIM "A"	DIM "B"	DIM "C"
3816	8-3/16" [208.0mm]	12-5/16" [312.7mm]	5-1/2" [139.7mm]
73380	8-3/16" [208.0mm]	12-5/16" [312.7mm]	5-1/2" [139.7mm]
1937	4-7/16" [112.7mm]	8-1/16" [204.8mm]	3-1/2" [88.90mm]
73381	4-7/16" [112.7mm]	8-1/16" [204.8mm]	3-1/2" [88.90mm]

ROUGH-IN:

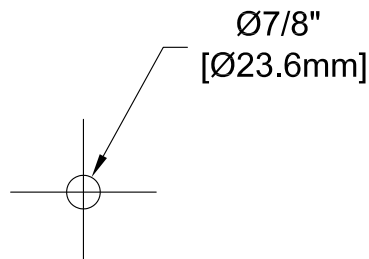

Replacement Parts for Single Base Deck Mount Faucets

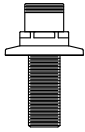

2903
BASE DECK

3966
6" RIGID
GOOSENECK SPOUT

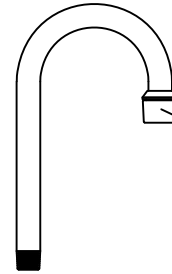

12564
2.20 GPM
AERATOR
OR
74223
0.35 GPM
AERATOR

73794
SLIP JOINT KIT

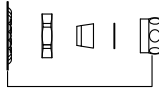

3969
12" RIGID
GOOSENECK SPOUT

