

Customer/Wholesaler:	Date:	Job Name:	Model Specified: 90430	Quantity:
Contractor:		Architect/Engineer:		

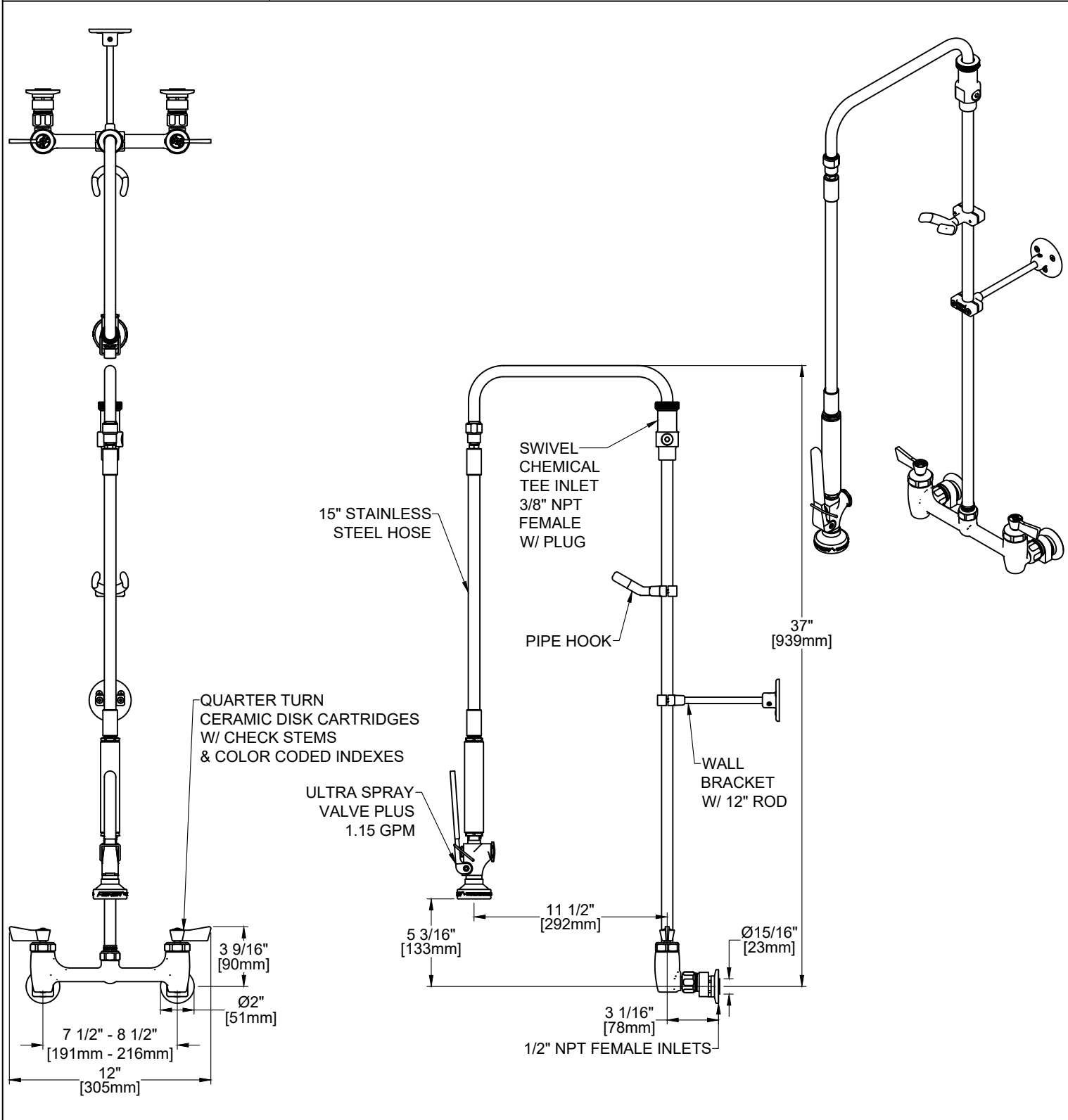

<p>PRODUCT SPECIFICATIONS: 8" ADJUSTABLE WALL SWIVEL PRERINSE UNIT 1.15 GPM @ 60 PSI, WITH CERAMIC CARTRIDGES, LEVER HANDLES</p>		<p>PRODUCT COMPLIANCE: ASME A112.18.1 / CSA B125.1 NSF 61 - Section 9 NSF 372 (Low Lead Content) 2019 DOE PRSV - Class II</p>	
--	--	---	--

Customer/Wholesaler:	Date:	Job Name:	Model Specified: 90430	Quantity:
Contractor:		Architect/Engineer:		

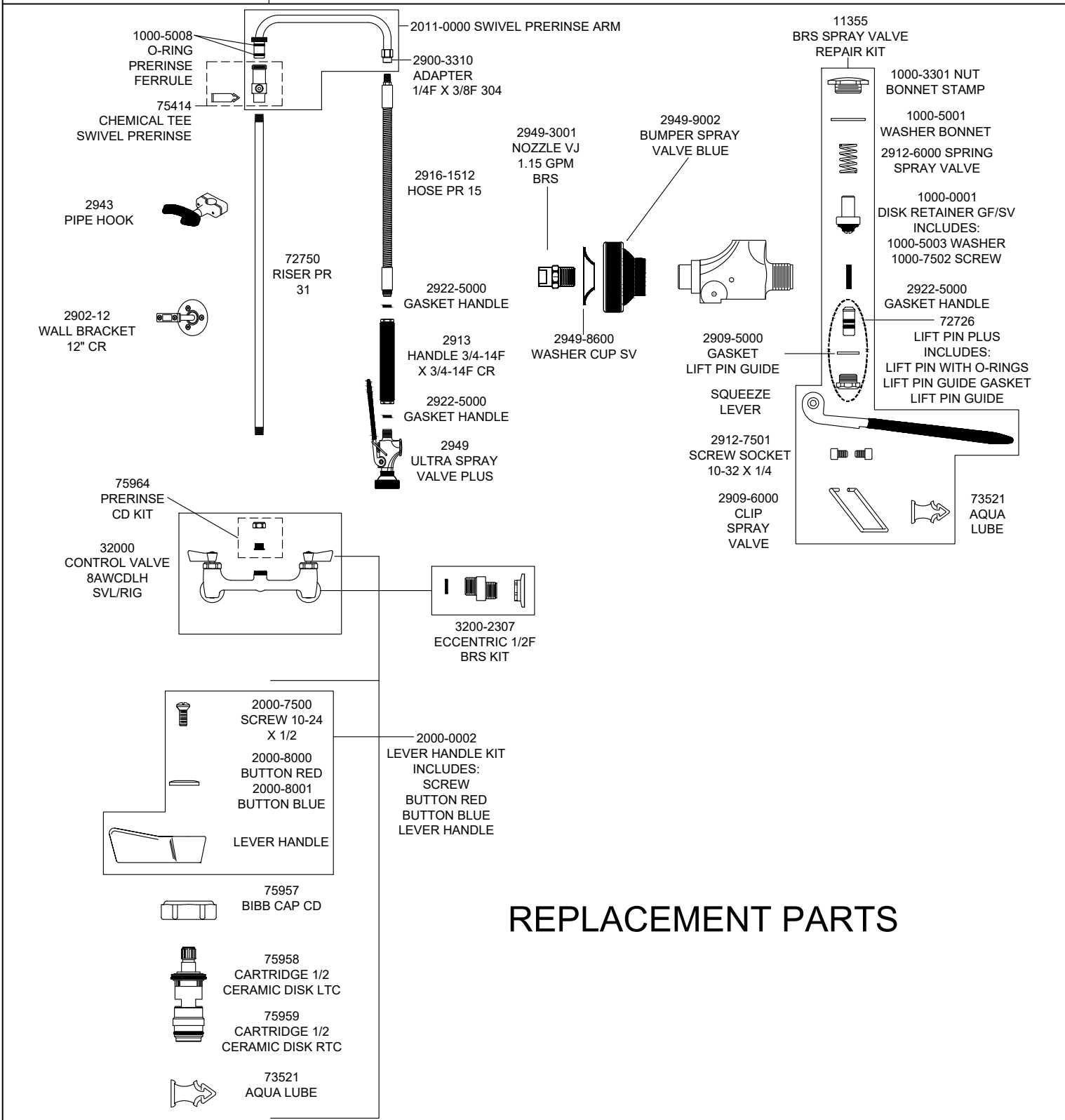

REPLACEMENT PARTS

PRODUCT SPECIFICATIONS: 8" ADJUSTABLE WALL SWIVEL PRERINSE UNIT 1.15 GPM @ 60 PSI, WITH CERAMIC CARTRIDGES, LEVER HANDLES

PRODUCT COMPLIANCE:
ASME A112.18.1 / CSA B125.1
NSF 61 - Section 9
NSF 372 (Low Lead Content)
2019 DOE PRSV - Class II

Drawn: LC	Checked: EM	Approved: LC	Date: 10/28/25	Sheet: 2 of 2
-----------	-------------	--------------	----------------	---------------